

# Boston National Historical Park Superintendent's Compendium Map C.2: Public Assembly Areas, Bunker Hill

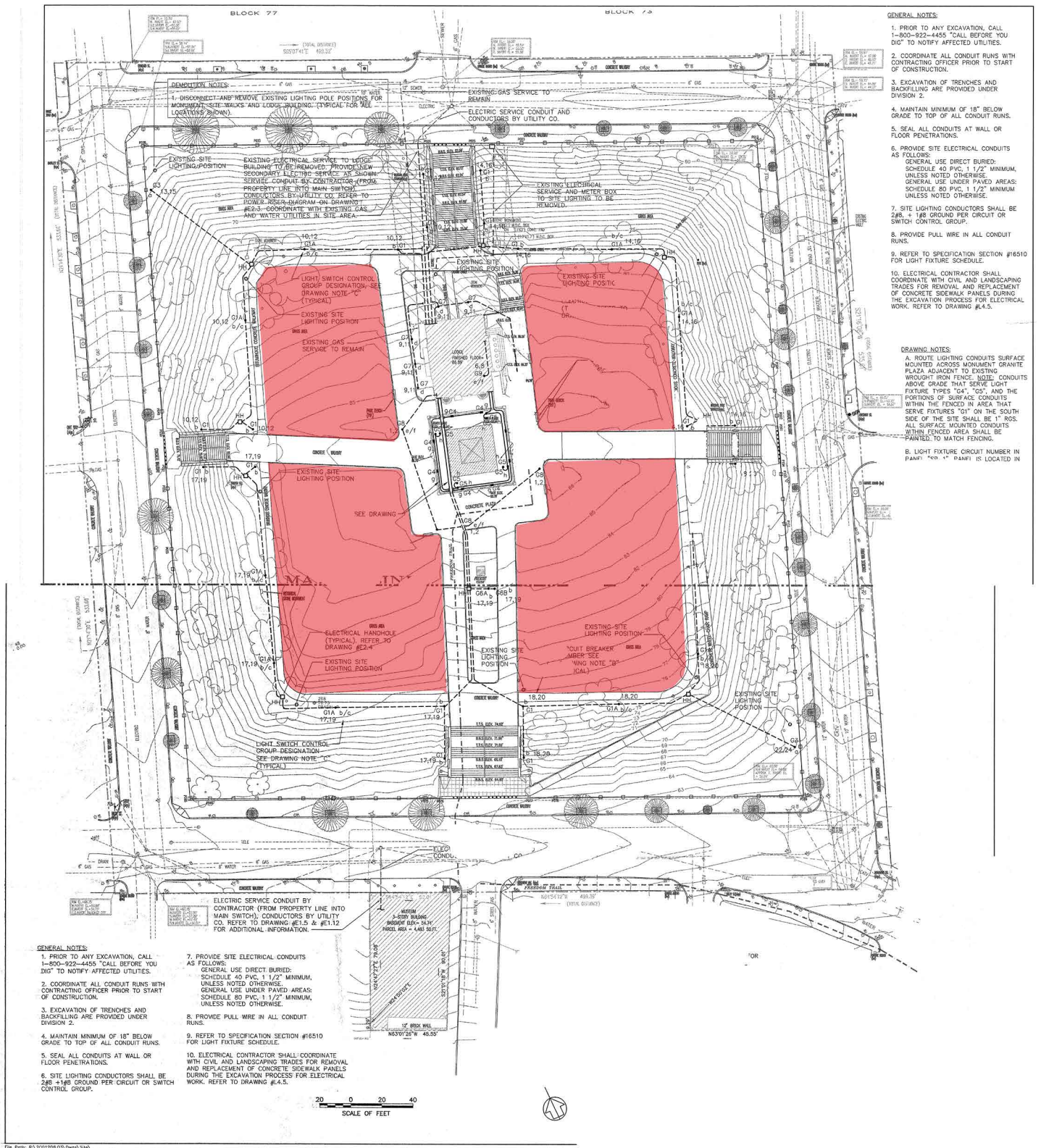

- GENERAL NOTES:**
1. PRIOR TO ANY EXCAVATION, CALL 1-800-922-4455 "CALL BEFORE YOU DIG" TO NOTIFY AFFECTED UTILITIES.
  2. COORDINATE ALL CONDUIT RUNS WITH CONTRACTING OFFICER PRIOR TO START OF CONSTRUCTION.
  3. EXCAVATION OF TRENCHES AND BACKFILLING ARE PROVIDED UNDER DIVISION 2.
  4. MAINTAIN MINIMUM OF 18" BELOW GRADE TO TOP OF ALL CONDUIT RUNS.
  5. SEAL ALL CONDUITS AT WALL OR FLOOR PENETRATIONS.
  6. PROVIDE SITE ELECTRICAL CONDUITS AS FOLLOWS:  
GENERAL USE DIRECT BURIED: SCHEDULE 40 PVC, 1 1/2" MINIMUM, UNLESS NOTED OTHERWISE.  
GENERAL USE UNDER PAVED AREAS: SCHEDULE 80 PVC, 1 1/2" MINIMUM UNLESS NOTED OTHERWISE.
  7. SITE LIGHTING CONDUCTORS SHALL BE 2#8, + 1#8 GROUND PER CIRCUIT OR SWITCH CONTROL GROUP.
  8. PROVIDE PULL WIRE IN ALL CONDUIT RUNS.
  9. REFER TO SPECIFICATION SECTION #16150 FOR LIGHT FIXTURE SCHEDULE.
  10. ELECTRICAL CONTRACTOR SHALL COORDINATE WITH CIVIL AND LANDSCAPING TRADES FOR REMOVAL AND REPLACEMENT OF CONCRETE SIDEWALK PANELS DURING THE EXCAVATION PROCESS FOR ELECTRICAL WORK. REFER TO DRAWING #4.5.

- DRAWING NOTES:**
- A. ROUTE LIGHTING CONDUITS SURFACE MOUNTED ACROSS MONUMENT GRANITE PLAZA ADJACENT TO EXISTING WROUGHT IRON FENCE. NOTE: CONDUITS ABOVE GRADE THAT SERVE LIGHT FIXTURE TYPES "G4", "G5", AND THE PORTIONS OF SURFACE CONDUITS WITHIN THE FENCED IN AREA THAT SERVE FIXTURES "G1" ON THE SOUTH SIDE OF THE SITE SHALL BE 1" RGS. ALL SURFACE MOUNTED CONDUITS WITHIN FENCED AREA SHALL BE "PAINED" TO MATCH FENCING.
  - B. LIGHT FIXTURE CIRCUIT NUMBER IN PANEL "CO. 1" PANEL IS LOCATED IN

- GENERAL NOTES:**
1. PRIOR TO ANY EXCAVATION, CALL 1-800-922-4455 "CALL BEFORE YOU DIG" TO NOTIFY AFFECTED UTILITIES.
  2. COORDINATE ALL CONDUIT RUNS WITH CONTRACTING OFFICER PRIOR TO START OF CONSTRUCTION.
  3. EXCAVATION OF TRENCHES AND BACKFILLING ARE PROVIDED UNDER DIVISION 2.
  4. MAINTAIN MINIMUM OF 18" BELOW GRADE TO TOP OF ALL CONDUIT RUNS.
  5. SEAL ALL CONDUITS AT WALL OR FLOOR PENETRATIONS.
  6. SITE LIGHTING CONDUCTORS SHALL BE 2#8, + 1#8 GROUND PER CIRCUIT OR SWITCH CONTROL GROUP.

7. PROVIDE SITE ELECTRICAL CONDUITS AS FOLLOWS:  
GENERAL USE DIRECT BURIED: SCHEDULE 40 PVC, 1 1/2" MINIMUM, UNLESS NOTED OTHERWISE.  
GENERAL USE UNDER PAVED AREAS: SCHEDULE 80 PVC, 1 1/2" MINIMUM, UNLESS NOTED OTHERWISE.
8. PROVIDE PULL WIRE IN ALL CONDUIT RUNS.
9. REFER TO SPECIFICATION SECTION #16150 FOR LIGHT FIXTURE SCHEDULE.
10. ELECTRICAL CONTRACTOR SHALL COORDINATE WITH CIVIL AND LANDSCAPING TRADES FOR REMOVAL AND REPLACEMENT OF CONCRETE SIDEWALK PANELS DURING THE EXCAVATION PROCESS FOR ELECTRICAL WORK. REFER TO DRAWING #4.5.

