

A T L A N T I C
O C E A N

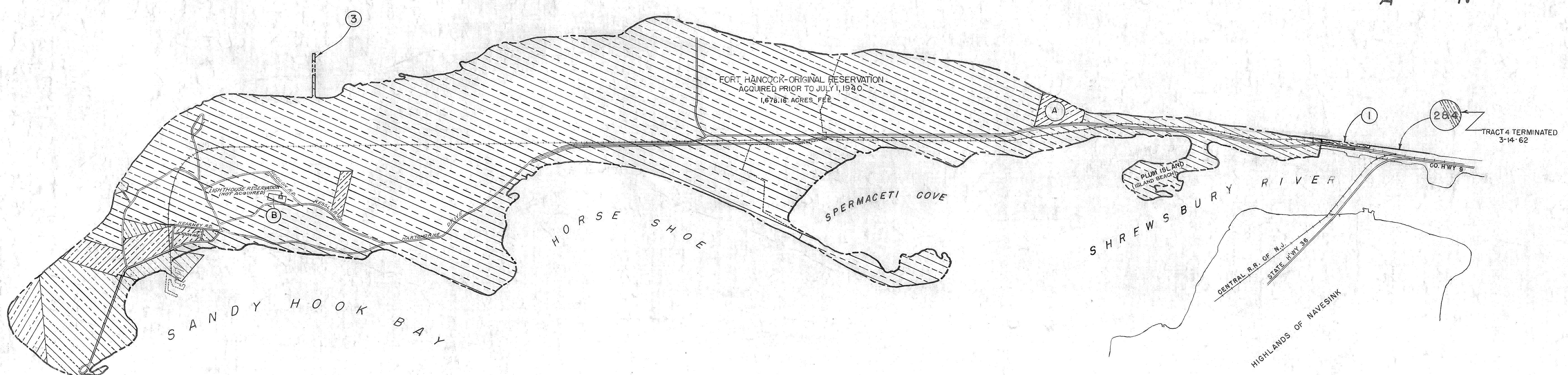

*NOTE: 11.80 ACRES (FEE) TRANSFERRED TO THE DEPARTMENT OF THE AIR FORCE ON 7 DEC. 1950, AND RETRANSFERRED TO THE DEPARTMENT OF THE ARMY ON 12 MARCH 1954

NOTE: THE BOUNDARY OF THIS INSTALLATION WAS COMPILED FROM DEED DESCRIPTIONS.

- 1,570.93 ACRES FEE, 1.14 ACRES EASEMENTS TRANSFERRED FROM SECRETARY OF THE ARMY TO THE SECRETARY OF THE INTERIOR EFFECTIVE 24 JANUARY 1978.
- 43.67 ACRES FEE, TRANSFERRED TO THE TREASURY DEPT. (U.S. COAST GUARD) ON 25 OCT. 1950.
- 41.12 ACRES FEE, OF ACCRETED LAND, TRANSFERRED TO CIVIL WORKS ACCOUNT (NY HARBOR CHANNEL IMPROVEMENTS, SANDY HOOK, N.J.) BY 1st IND FROM ASA (I&L) DATED 27 JULY 1971.
- 18.31 ACRES FEE, TRANSFERRED TO THE DEPT. OF TRANSPORTATION (U.S. COAST GUARD) BY LETTER FROM THE SECRETARY OF THE ARMY EFFECTIVE 29 NOVEMBER 1972.
- 11.80 ACRES FEE, TRANSFERRED TO THE DEPARTMENT OF THE AIR FORCE ON 7 DECEMBER 1950.
- 5.80 ACRES FEE, TRANSFERRED TO THE DEPT. OF TRANSPORTATION (U.S. COAST GUARD) BY LETTER FROM THE SECRETARY OF THE ARMY EFFECTIVE 8 JULY 1976.

LICENSE NO. W-1098-ENG-1637, NO AREA, DATED 6 JULY 1942 WAS TERMINATED 14 MARCH 1962.
PERMIT NO AREA, DATED 9 APRIL 1942, WAS TERMINATED 8 APRIL 1943.

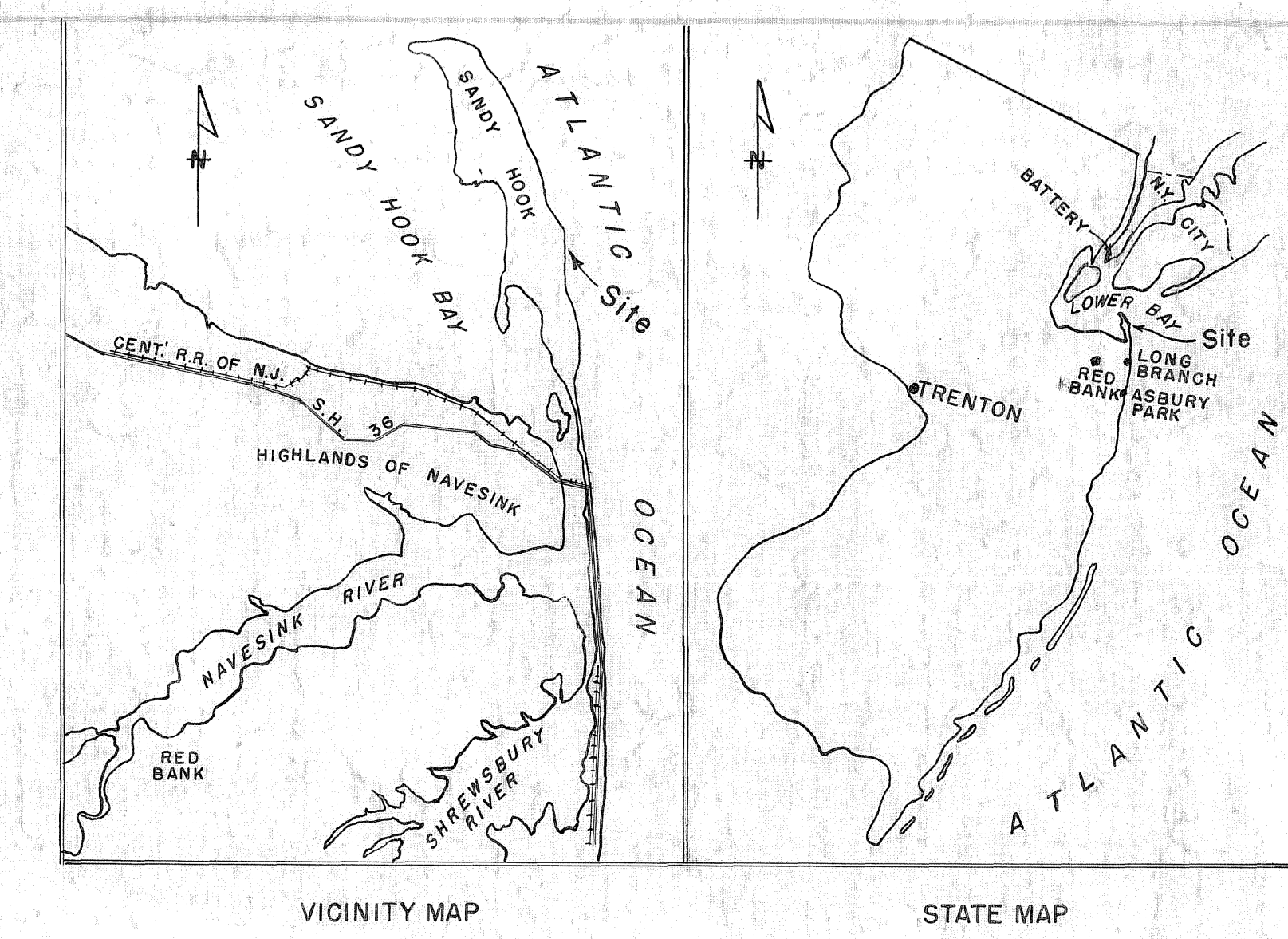

FINAL PROJECT MAP
STATE NEW JERSEY
COUNTY MONMOUTH
DIVISION NORTH ATLANTIC DIVISION
DISTRICT NEW YORK
DEPARTMENT OF THE ARMY
USING SERVICE 1ST ARMY
16 MILES SOUTH OF THE BATTERY IN N.Y.C.
AT NORTH END OF SANDY HOOK N.J.

TRANSPORTATION FACILITIES
RAILROAD
STATE ROAD
FEDERAL ROAD
AIRLINE

LAND AREA
ACRES ORIGINAL RESERVATION FEE 1678.16
ACRES EASEMENT 1.14
ACRES LEASED FROM W.D. 1.67
ACRES TRANSFERRED (FEE) (11.80)*
ACRES TOTAL 1692.77
ACRES LESSER INTERESTS { PERMIT (1) NO AREA
LICENSE (1) NO AREA
DISPOSALS 1692.77

ACRES SOLD (FEE) 1679.83
ACRES TRANSFERRED (FEE) *(11.80)
EAS (1) 1.14
ACRES LESSER INTERESTS TERMINATED LICENSE (1) NO AREA
PERMIT (1) NO AREA

LEGEND
RESERVATION LINE
STATE OR PROVINCE LINE
COUNTY LINE
CIVIL DISTRICT PRECINCT
LAND GRANT LINE
CITY, VILLAGE, OR BOROUGH
CEMETERY SMALL PARK ETC.
TOWNSHIP LINE
SECTION LINE
SCALE
1" = 1200'
1200' 600' 0 1200' 2400' 3600'

TRACT NO.	VENDOR	ACRES	ESTATE
1	HELEN J.B. HENRY JAMES SANDLASS, TRUSTEES	1.14	PEASEMNT
2	STATE OF NEW JERSEY		PERMIT
3	STATE OF NEW JERSEY		PEASEMNT
4	THE CENTRAL RAILROAD CO. OF NEW JERSEY		LICENSE
A	DEPARTMENT OF THE AIR FORCE	*(11.80)	FEE
B	UNITED STATES COAST GUARD	1.67	FEE

TRANSFERRED EFFECTIVE 3-1-60

ACQUISITION AUTHORIZATION

RE-D 773 (GENERAL) DATED 4-10-42
RE-D 1890 " 11-4-42
RE-D 1890 A (GENERAL) " 1-1-43
LETTER OF TRANSFER IN LIEU OF FORMAL DIRECTIVE " 3-12-54
RE-D 7324 " 12-15-59

MICROFILMED	DATE	REVISIONS	BY
	6-9-64	AREA OF ORIGINAL RES. CORRECTED	P.B.
	6-9-64	DUE TO REVISED AUDIT	P.B.
	22/9/76	AREA OF PREVIOUS DISPOSAL CORRECTED	M.A.C.P.
M	2-23-78	DUE TO FINAL DISPOSAL & REAUDIT	R.I.

INSTALLATION NO. 366
AUDITED
O.C.E. APPROVED 3-6-80

WAR DEPARTMENT, O.C.E.
CONSTRUCTION DIVISION
REAL ESTATE
FORT HANCOCK N.J.
MILITARY RESERVATION
RECOMMENDED *Linwood B. Day* ENGINEER (C&D) DATE 6 MAY, 1947
APPROVED *J. A. Houston* DIVISION R.E. OFFICER DATE 6 MAY, 1947
COMPILED: F.T. TRACED: F.T. CHECKED: F.T.
DATE BY REVISIONS
2-1-51 P.B.B. DUE TO DISPOSAL
7-12-54 P.B.B. DUE TO RETRANSFER
13-15-60 P.B.B. DUE TO TRANSFER
5-19-60 P.B.B. DUE TO SUPPLEMENTAL AUDIT
5-22-62 P.B.B. TRACT 4 TERMINATED
SHEETS 1 OF 1
FILE
m
L.B.
I.D.
P.B.B.
NU 481