

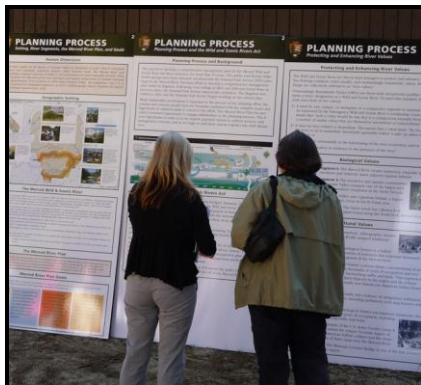

Meeting Summary Merced Wild and Scenic River Plan Wawona Community Workshop

October 28, 2011





EXECUTIVE SUMMARY

Introduction

The Merced River Plan will provide overarching guidance for river protection and public use within the Merced Wild and Scenic River corridor inside Yosemite National Park. The overall goal of the plan is to “protect and enhance the values for which the river was designated wild and scenic leaving the river unimpaired for future generations.” The Wawona Community Workshop was the second of six meetings held in October and November 2011 to gather community input on preliminary management considerations and options. This input will be used to develop management alternatives for the Merced River. Draft alternatives will be available for public review in Spring 2012 and will be analyzed in the Environmental Impact Statement to be released in Summer 2012. Community input received during scoping in 2007 and 2009 through 2011; and during the community workshops in Spring 2011 will be considered in developing alternatives. The alternatives will also reflect the findings of the numerous scientific and socio-cultural studies that have occurred over the past year. Ultimately, each alternative must reflect the goals of the Merced River Plan and protect and enhance the river’s outstandingly remarkable biological, geologic/hydrologic, cultural, scenic, and recreational values, as well as water quality and the river’s free flowing condition.

The Wawona Community Workshop for the Merced River Plan was held on October 28, 2011 from 1:00 p.m. to 5:00 p.m. Approximately 19 participants attended the workshop. Most were residents of or property owners in Wawona, California.

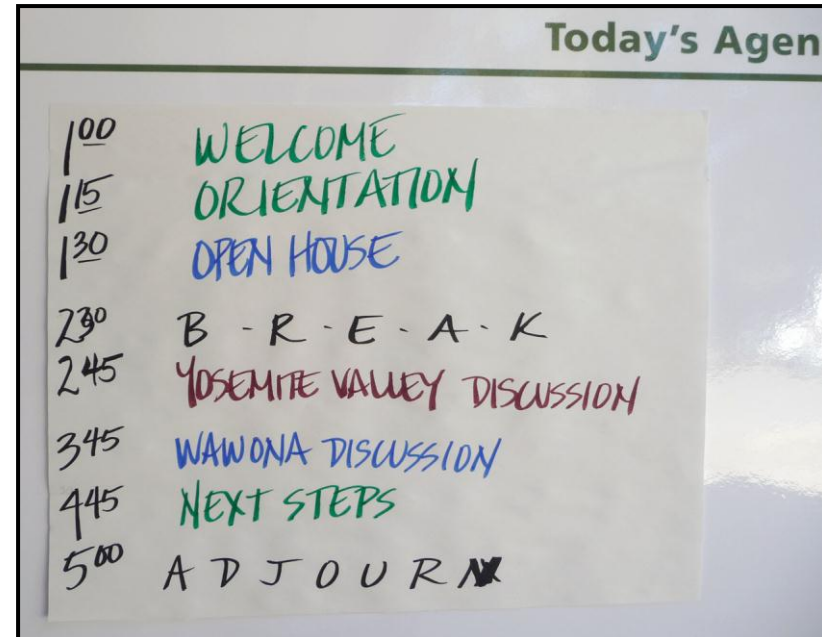



Merced River Plan: Wawona Workshop

The Wawona workshop had four parts:

- Part 1: Welcome and Orientation (detailed description is included in Appendix 1: Meeting Notes on page A1-1) – This part of the workshop included an overview of the agenda; a description of the planning workbook including the planning process, Merced River Plan goals, and outstandingly remarkable values; and an explanation of the display board exercise.
- Part 2: Open House – Participants reviewed the display boards and the Merced Wild and Scenic River Planning Workbook and commented on the Merced River management options. Participants also used colored dots to identify which options they wanted to discuss in the group discussions. Comments received on the various management options are included in Appendix 2: Display Board Comments beginning on page A2-1.
- Part 3: Small Group Discussion – Participants gathered in small groups to discuss the management options of greatest interest to them based upon the placement of their colored dots. The topics that emerged as most important to this group are listed below. The small group comments are incorporated into this Executive Summary and are included in their entirety in Appendix 1: Meeting Notes, page A1-4.
 - Camping (Management Considerations 9, 12, 14 and 23)
 - Paddling and Floating/Large Woody Debris Management (Management Considerations 6 and 18)
 - River Access (Management Considerations 21 and 22)
 - Bridges (Management Considerations 6 and 10)
 - Merced Lake High Sierra Camp/User Conflicts (Management Considerations 2 and 4)
 - Backpacking (Management Considerations 3 and 5)
- Part 4: Large Group Discussion – The final part of the meeting was a group discussion about Wawona and the management issues and opportunities unique to the community. The large group comments are incorporated into this Executive Summary and are included in their entirety in Appendix 1: Meeting Notes, page A1-8.

“The experience you get from camping in the Valley is unique.”



Transportation, Traffic and Parking

Several people suggested that the congestion in the Valley is a result of removing parking as part of the 1980 GMP. Public transit has not developed to accommodate for the reduced number of parking spaces. Cars, parking and public transit are linked and one cannot be limited without considering the impact on the other two.

Merced Lake High Sierra Camp/User Conflicts

Participants generally supported retaining Merced Lake High Sierra Camp stating it is a part of the area's character, contributes to the ORV, and provides a way for people who do not backpack to experience the wilderness. One person opposed the idea of using helicopters to bring in supplies and suggested using human volunteers instead. One person felt the mule smell was an issue. One person suggested user capacity should be determined before any decisions are made.

Wawona

Wawona Store

All participants expressed concern over parking and congestion at the Wawona Store. Issues include the number of tour buses, the number of people waiting for tour buses, and the park shuttle. Much of this crowding stems from visitors to Mariposa Grove and the prohibition on buses. It was suggested that additional parking for Mariposa Grove be added at the South Entrance.

Parking

Most participants expressed concern over the significant parking issues in Wawona. Several participants suggested a new parking area across the river by the maintenance yard. Pedestrians could walk across the covered bridge.





Restrooms

Most participants agreed that restrooms were needed at Flat Rock and Swinging Bridge. Areas where there is concentrated swimming should have restrooms.

River Access

Several participants suggested retaining campsites at the river's edge and removing logs blocking access to the water. One person suggested building boardwalks at the river's edge.

Section 35 and Other Private Lands

It was noted that there was no mention of the Section 35 inholding. A few people suggested that signs should be posted prohibiting river access from private lands.

Sewer Plant

Several people expressed concern over sewer plant capacity and its impact on new housing in Wawona, especially when the new campground is added to the system.

“A lot of the comments are about getting rid of things. This creates a tension around the constituents of these activities. Need ways to increase rather than decrease.”





APPENDIX 1: MEETING NOTES

Part 1: Welcome and Orientation

Ed Mee, Chairman of the Wawona Town Planning Committee (WTPC) opened the combined WTPC and National Park Service meeting stating that this was an informational meeting on the Merced River Plan.

Kathleen Morse of the National Park Service welcomed the group and provided background on the planning process. She stated that this was the second public meeting with three additional meetings in Yosemite Valley and San Francisco, and webinars scheduled in November, 2011. She described the project team's planning process of studying each river segment to identify its management considerations and options. She asked the audience to comment on whether the park has missed anything in its analysis and to provide comments on the options. She mentioned that these meetings were an opportunity to participate in the planning process as it evolves.

Laurie Durnell of The Grove Consultants International stated that the meeting purpose was to gather feedback to be used to develop a set of alternatives for different sections of the Merced River.

Jim Oswald, also of The Grove provided an overview of the agenda and ground rules. He encouraged the participants to fill out their workbooks and return comments by November 30. He explained the planning process diagram and explained that the park held a series of workshops in the spring on specific issue areas. The information from these meetings allowed the park to develop the options in the workbook but that there were no conclusions or proposals presented at this meeting, simply ideas for comment. He stated that the site plans were ideas about different ways to respond to issues that have been raised.





Audience Questions and Comments

- *“Previously the project deadline was December 2012 and now it is mid-2013. Did the judge hold the park to interim dates or just to end dates?”*

Park Response: Kathleen Morse responded that the park is committed to end dates.

- *“I am concerned that schedules are always in cartoon form and there is no real sense of schedule.”*
- *“Why was there a six month extension?”*

Park Response: Kathleen Morse responded that at the outset of the process there was not sufficient science to do the EIS analysis. The park has completed a full season of research that provides a solid scientific basis for analysis. Having a sound scientific basis provides clarity on many of the issues and is defensible in court. She stated that the plaintiffs supported the extended timeline.

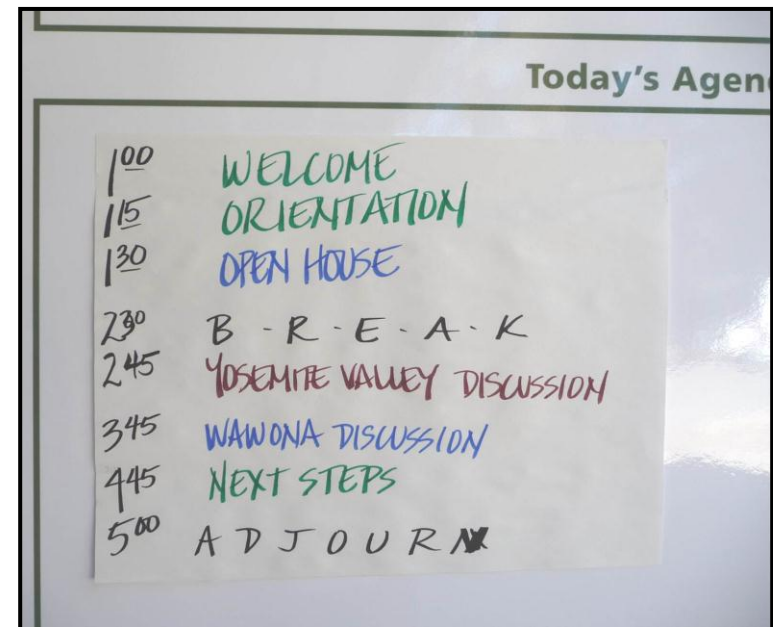

Laurie Durnell of The Grove resumed the opening orientation, pointing out the highlights of the workbook. She explained the color coding of the goals throughout the workbook and wall boards stating that the color coding system indicates which management considerations help address which goals. She provided an overview of the river segments, designations, and the river’s outstandingly remarkable values.

She addressed the overall planning goal of leaving the river unimpaired for future generations and stated that the challenge of the planning process is to balance the four goals. This creates tension between different goals.

She concluded by explaining the Open House portion of the workshop. Participants were asked to identify the management options that they would like to discuss by tagging with either a green or a red sticky dot. A green dot meant the participant thought the option was going in the right direction, and a red dot indicated that the participant didn’t like the option. Both colors of dots indicated that the participant wanted to talk about the option. If participants had comments they were asked to write them on green and red sticky notes.



Jim Donovan, NPS provided an overview of the site plans for Yosemite Valley, Wawona, and El Portal. He stated the goal of the maintenance yard options was to create a better entrance to the city and separate buildings and grounds from maintenance. Use would be condensed in the maintenance yard and a buffer would be created between park operations and the river. He noted that some of the buildings in the maintenance yard are historic.

The goal of the Wawona Store site plan is to move parking off the road and provide shuttle parking. He stated that the Mariposa Grove/South Entrance Station is a separate project. A new parking facility is being considered as part of that project.

He stated that the Wawona plan only applies to park service areas and not to private areas. In response to a question about whether the Wild and Scenic Rivers Act applies to private property, he responded that a private property owner must apply to the Army Corps of Engineers for a permit. The Wawona Town Plan helps manage the town's private lands.

Part 2: Open House

Participants spent approximately an hour placing dots and comments on the display boards. Each board addressed one of the river segments and included an area to comment on the potential management options for that segment. Not all management options received comments. Any comments received on the management options are included in Appendix 2. Comments and dots were also placed on the preliminary site plans for the Wawona Store and the maintenance yard. These are also included in Appendix 2.





Part 3: Small Group Discussions

Laurie Durnell of The Grove identified the management opportunities that were of greatest interest to the group. These were:

- Camping (Management Considerations 9, 12, 14 and 23)
- Paddling and Floating/Large Woody Debris (Management Considerations 6 and 18)

Laurie clarified the interconnection between the two issues above stating that rafting and floating safety is potentially intertwined with the amount of large woody debris which is an important part of aquatic habitat.

- River Access (Management Considerations 21 and 22)
- Bridges (Management Considerations 6 and 10)
- Merced Lake High Sierra Camp/User Conflicts (Management Considerations 2 and 4)
- Backpacking (Management Considerations 3 and 5)

Camping

- *“Put camping in places it was before.”*
- *“Ecological reasons that camping couldn’t return there.”*
- *“There may be better uses for these sites.”*
- *“The experience you get from camping in the valley is unique. You aren’t in the flow of traffic.”*
- *“When looking at creating more camping, don’t look at the number of campsites now or the old number but arrive at some number in between.”*





- *“User capacity piece is fundamental. Need to see the numbers before you can identify how much we can put in.”*

Public Transit

- *“Can’t come into park to camp on public transit easily.”*
- *“Can’t imagine any way for people to bring what they bring in their cars for camping on public transit. Once in the camp people could use public transit.”*
- *“Younger people are more likely to use public transit into valley for camping. They bring less stuff.”*
- *“Underlying principle is access – people want Yosemite to be accessible.”*

Traffic and Camping

- *“Because we took away Rivers Campground it created a day use structure around transportation in the Valley and exacerbated the traffic situation. More campgrounds would result in fewer cars on the roads and would open up 75 or 100 parking spaces.”*
- *“Day use vs. overnight people – the mix has changed since flood but the whole number of visitors has increased. More camping won’t change or reduce congestion. The only way to do this is to put a ‘full’ sign at the door. Campers will drive around like everyone else.”*
- *“In some parks, if you camp in the park, you must leave your car in your campsite and if you drive it around they throw you out. Denali does this.”*
- *“Would it reduce traffic if the only personal transportation was people staying the night?”*

Reservations and Permits

- *“With a permit system, how do you handle people who come in one entrance and out another?”*
- *“At some point we may have to limit who will come in. It will get to that point. There will be more people as time passes. NPS needs to think about it.”*



- *“No support for reservations.”*

Pedestrian Circulation

- *“Strong support for pedestrian under-crossings.”*

Parking

- *“Much of the congestion was created due to removal of parking.”*
- *“Twenty years ago the Park’s goal was to reduce the number of vehicles in park. They removed gas stations and reduced parking spaces from 1500 to 530. They hoped public transit would develop but it didn’t.”*
- *“If you are going to allow cars need places for them to park. Now people make their own parking lots like the double parking on Southside Drive. Cars and parking places and alternative transportation – can’t limit one without thinking of consequences on the others.”*

Backpacking

- *“Backpacking and solutions proposed involved abuse of resources. There are solutions other than limiting the number of backpackers – use education or other methods.”*

General Transportation

- *“To travel from Wawona to Tioga you have to go half way down the valley. This adds to congestion and travel time.”*

Merced Lake High Sierra Camp

- *“Merced Lake High Sierra Camp needs to stay. Comments about the negative impact on views of the area is an issue in the mind of the beholder. The High Sierra Camps are part of Yosemite’s historic character. The view of the tents may even be an ORV. Camps allow people who might not otherwise be able to access the back country. It’s a fantastic experience that Yosemite has offered throughout the years.”*



- *“How do you serve people? Need to avoid the mule smell.”*
- *“High Sierra Camp serves a function that contributes to the ORV rather than detracting from it.”*
- *“Merced Lake High Sierra Camp is a destination – it gives you a place to go and a place to concentrate NPS people. If no High Sierra Camp people won’t go there.”*
- *“Don’t want Merced Lake High Sierra Camp served by helicopters. Consider using human volunteers to bring in supplies.”*
- *“Merced Lake High Sierra Camp gives people who can’t backpack a way to get to the backcountry. Facilities support this as long as they are working properly.”*
- *“A lot of the options are about getting rid of things. This creates a tension around the constituents of these activities. Need ways to increase rather than decrease.”*
- *“Before we decrease we need to know what user capacity...what can resource handle?”*

Part 4: Large Group Discussion – Wawona

Wawona Store Crowding

- *“Concerns about the store area. Eliminating any parking may be overkill. Parking is needed. Place gets really busy. After 8:30 a.m. you don’t want to go there. There is a high volume of buses – 7 to 8 at a time – plus the in park shuttle system using this area. People waiting between buses occupy the picnic area. Pedestrian congestion.”*
- *“Crowds at store goes back to Big Trees...overflow from that parking lot feeds this. Won’t let buses drive to Big Trees. Need more parking for Big Trees but the parking issue alone doesn’t tell full story. Huge impact on the community.”*



Parking

- “Support for more parking on the other side of the river in area where maintenance area is being reduced. Pedestrians can walk over covered bridge”
- “Parking in the Grove is having an impact on the Big Trees. The park is studying how to accommodate parking at the Grove but remove from sensitive areas. The Draft Mariposa Grove Project EIS is due in Summer/Fall of 2012.”



Camping

- “New camping area is not favorable.”
- “Keep sites next to the river in Wawona Campground.”



Workbook Comments

- *“Map location is incorrect for floating and paddling.”*

Section 35

- *“In Wawona discussion there was no mention of the existence of Section 35. This is a significant inholding. Doesn’t do description of area justice.”*

Facility Needs

- *“Behind this meeting location is a swimming hole used by visitors but no restroom facilities. Also area by Swinging Bridge – need restrooms.”*
- *“Deals with what park is planning but visitation affects everyone here. Restrooms. Just up the road from where studied.”*
- *“Throughout Wawona there is a patchwork of private and NPS property. Access to the river across private property is an issue. Need designated areas with public access and a way to identify those where access is prohibited.”*

Sewer Plant Capacity

- *“If I owned a lot in Wawona it may be that I cannot build due to sewer system capacity and would need septic. Once campground hooks up what happens to other people who want to tie into the sewer system?”*

Staff Response: Jim Donovan, NPS responded that Facilities Management is studying how to link up the campground. Sewage needs to be pumped. The sewer plant is close to the legal limit of how much can be processed in a day. One solution is a leach field. When that occurs it may free up capacity for private property. Private property would have difficulty connecting up now.

- *“In summer, effluent is put on the golf course. Permit by RWQCB to discharge but this has not been done it in many years. When the weather is too cold to put it on the golf course, effluent is stored in tanks for fire. When space is limited in tanks, what do we do with effluent?”*



- *“Surprised to hear plant is at capacity. Told it was built in anticipation of more park service housing.”*

Funding

- *“Is any of this going to happen since the government is broke? Is there government money available for this?”*

Staff Response: Kathleen Morse, NPS responded that the park intends to keep the plan realistic and implementable with implementation timing spread out over years. We will look years ahead and put projects into future budgets. A large portion of park funding comes from the Conservancy and gate fees, not appropriated government dollars. The plan will not be like the original YVP.

Marty Nielson, NPS stated that 80% of entrance station funds are returned to the park and are used for infrastructure projects. Our planning has to be realistic fiscally. Several management plans have been redone due to cost. The community should consider priorities as we move through this process.

Closing

Laurie Durnell concluded the meeting with a summary of next steps. A newsletter will be released in Spring 2012 describing the preliminary alternatives to be analyzed in the EIS. Workbook comments are due November 30th. She also provided dates and locations for the upcoming workshops and webinars.

Q: *Are web meetings recorded?*

A: Notes are taken on all comments that come in and Webinars are recorded and put on website. yose.webex.com is the permanent webinar site.

Q: *Are Summer 2010 comments still being considered?*

A: These comments, as well as all scoping comments will be considered as the alternatives are developed.



Tabletop Worksheets

Each table group was provided with a worksheet divided into sections for each river segment (Segment 1, Segment 2, Segment 4 and Segment 5 through 8). During the small group exercise participants were asked to add comments to the worksheet as they saw fit. The following are the comments sorted by topic as written by meeting participants.

Floating and Paddling/Large Woody Debris

- *“Don’t burn down the barn to get the rats out of the hay.”*

Merced Lake High Sierra Camp

- *“Keep High Sierra Camps open. Stock use isn’t a significant conflict.”*
- *“Separate stock trail; Clean up manure; Put up with horse poop.”*
- *“Use helicopter in addition to stock to support High Sierra Camp.”*
- *“Helicopter use to High Sierra Camp – not the place for helicopters instead of horses.”*
- *“The camps should not be serviced by helicopter. Mule train is fine.”*
- *“Consider using human volunteers to carry supplies as an alternative to stock use or helicopters. Volunteers get free entry to Park.”*
- *“Mule poop is not enjoyable to walk through. I am tired of walking through mule poop. It smells.”*
- *“Others don’t have a problem with the mule smell.”*
- *“The camps contribute to the character. Part of the historic fabric.”*
- *“The camps provide a historic feeling. The tents are charming.”*
- *“Like the High Sierra Camp. Why do we want to get rid of it?”*
- *“Like the High Sierra Camp because it allows people to access the back country that can’t physically handle backpacking.”*



- *“Having High Sierra Camp allows those over 60 a means to see back country. Should not take away or limit this service.”*
- *“Be sure facilities are there (toilets) to protect the river.”*
- *“Need to limit sites that are highly accessible for these places to receive that protection.”*
- *“Reduce abuse rather than number of campers.”*

Wawona

- *“Public needs to be well informed about Section 35 being private property and these properties (on the river) need to be enforced for No Trespassing by visitors.”*

El Cap Meadow

- *“Perpendicular parking in El Cap Meadow.”*

Camping and Camping Demand/Lodging

- *“Removing campgrounds shuts out young families.”*
- *“Feeling that camping creates tradition and family experience not for the elite but for all.”*
- *“Campground hosts could help enforce policies and regulations and create a more engaging experience for campers.”*
- *“Suggest removing the infrastructure annually – bear boxes and barriers.”*
- *“Flooding in campground doesn’t happen frequently and doesn’t cause too much disturbance.”*
- *“Don’t understand why the Rivers Campground was removed.”*
- *“Support for restoring camping at Rivers Campground. RV and tent mixture.”*
- *“Like to see the campgrounds at former Rivers returned.”*
- *“Sentiment that Park used flood as an excuse to remove Rivers Campgrounds.”*



- *“Removing Rivers Campground creates a day use issue – great number of cars coming in to the Park because they can’t stay overnight.”*
- *“Greater number of campgrounds in the Valley would result in fewer people on the roads.”*
- *“Concern that increasing camping could lead to increased demand for all overnight accommodations.”*
- *“More camping demand because of increased number of visitors not just because campsites lost.”*
- *“Increase camping in Valley. More cars entering because no camping in the Valley for them.”*
- *“Need to know numbers of day/night use before looking at additional camping. Would more camping decrease day use and vehicular traffic?”*
- *“Campsite loss can be seen as both negative and positive (to resources and river).”*
- *“Campsites reinstated farther from river.”*
- *“Could there be a middle number?”*
- *“Can’t camp by public transportation (but shuttle works great when you are in the Valley).”*
- *“Overnight stay will always be ruining Yosemite in summer.”*

Transportation and Congestion

- *“Experience negatively impacted by driving in and out, by high volume of traffic.”*
- *“Most people have too much stuff to have to put it on a bus.”*
- *“Seasonally opened parking areas in Valley.”*
- *“Shuttles to Valley and to other places in the Park.”*
- *“Pedestrian undercrossing at two problem intersections.”*
- *“Expand the number of shuttles from Wawona and length of time/duration of stay.”*



- *“Can there be a short term fix to create a safer Highway 41 corridor through Wawona? Currently there is parking on both sides of 41 from the Golf Course north to long turnout past Chilnualna Falls Road creating a driver and pedestrian safety issue.”*
- *“Traffic – need to go through El Cap crossover to get to Tioga from Wawona/Route 41. Alternative is to allow two way traffic.”*

User Capacity

- *“Need to discuss user capacity earlier in the process.”*
- *“Capacity not mentioned here – but we need the numbers.”*

Other

- *“Valley is a “sacrificial lamb” that entices people to want to protect the whole.”*
- *“Why are we eliminating High Sierra Camp, camping, parking, access, etc.?”*
- *“Continuing to remove things from the Valley – will lose key constituencies. Particularly in regards to tax revenues.”*



APPENDIX 2: DISPLAY BOARD COMMENTS

SEGMENT 1: Merced River Above Nevada Fall

Visitor Use Management Program

Management Consideration 2: Recreational User Conflicts

Management Option 2A: Close or reduce Merced Lake High Sierra Camp capacity (to 42 beds (as above) or less) to limit concessioner stock use.

- “Leave as is”

Other Comments:

- “The way visitors experience the park comes in many different forms. Not everyone can hike long distances. Keep trails available to horses.”

Land Uses and Associated Development

Management Consideration 4: Merced Lake High Sierra Camp: Wilderness and ORV Impacts

Management Option 4B: Reduce capacity from 60 beds to 42 beds (equal to that of the next largest camp (Vogelsang)).

- “Leave as is”

SEGMENT 2.1: East Yosemite Valley

There were no comments on the interactive boards for this segment.

SEGMENT 2.2: Yosemite Village Area

There were no comments on the interactive boards for this segment.



SEGMENT 2.3: Yosemite Lodge Area

Visitor Use Management Program

Management Consideration 19: Valley: Camping Demand

Other Comments:

- *“Restore flooded campgrounds. Yearly if needed.”*

SEGMENT 2.4: West Yosemite Valley

Ecological and Natural Resource Values

Management Consideration 21: El Cap Meadow: Informal Social Trails

Other Comments

- *“Allow access to river in valley that is upriver from Housekeeping Cabins.”*
- *“It would lessen traffic in valley if one did not have to drive down to El Capitan Bridge to go to Tioga Road from Wawona. Use current road which is now one way by Bridal Veil.”*

SEGMENT 4: El Portal

There were no comments on the interactive boards for this segment.



SEGMENT 5, 6, 7 and 8: South Fork Merced River Wawona

Ecological and Natural Resource Values

Management Consideration 29: Wawona Campground: Campground Activity Near River

General Comments:

- *“If the campground is put on the Wawona sewer system which is already at near capacity, what will a property owner be faced with if they want to build on their property? Can they hook up to the sewer system? Is the Camp Wawona expansion to be accommodated within this use of the Wawona sewer system?”*
- *“How about a boardwalk (similar to what is used in swamps) to protect the river shore?”*

Opportunities for Direct Connection to River Values

Management Consideration 30: Camp A.E. Wood

General Comments

- *“Use limited funds for more important projects.”*
- *“No reduction in overall number of camp sites.”*

Visitor Use Management Program

Management Consideration 31: South Fork: Paddling and Floating

General Comments:

- *“Identify river access points to reduce impacts to private property.”*
- *“How to keep paddling and floating from happening on private property?”*



- *“Add composting toilets at Swinging Bridge and Flat Rocks of Wawona.”*
- *“Permits for boaters necessary.”*
- *“Paddling above the containment dam?”*
- *“Add public restrooms at Flat Rock and Swinging Bridge.”*

Land Uses and Associated Development

Management Consideration 33: Impoundment: Effects on Free-Flowing Condition

Management Option 33A: Investigate reasonable Management Options, such as water system development from Biledo Spring or Big Creek. Retain the impoundment until other Management Options are developed.

- *“Don’t disturb Biedo Meadows area.”*

Miscellaneous Wawona Comments

- *“Parking overcrowding is due to big trees! Use shuttles. Add more parking for grove access at south entrance.”*
- *“Remove fallen trees in campground that hinder beach access. . . such as the two fallen trees in middle of large beach, riverside from the amphitheater.”*
- *“Rest rooms for Swinging Bridge area.”*
- *“Limit growth of SDA camp beyond current use.”*
- *“In the workbook section concentrating on Wawona and the South Fork there is no mention of the Section 35 Buildings. Why?”*



YOSEMITE NATIONAL PARK WAWONA GENERAL STORE CONCEPT

WAWONA GENERAL STORE CONCEPT

- 1 BUS SHELTER (250 OSP)
- 2 RESTROOM FACILITY (500 OSP)
- 3 (6) TOUR BUS/SHUTTLE BUS PARKING SPACES
- 4 (120) PARKING SPACES
- 5 RESTORATION AREA (DELETE EXISTING BUS PARKING AREA)
- 6 RESTORATION BUFFER ZONE (MAINTAIN EXISTING PLANTINGS)
- 7 MERCED RIVER

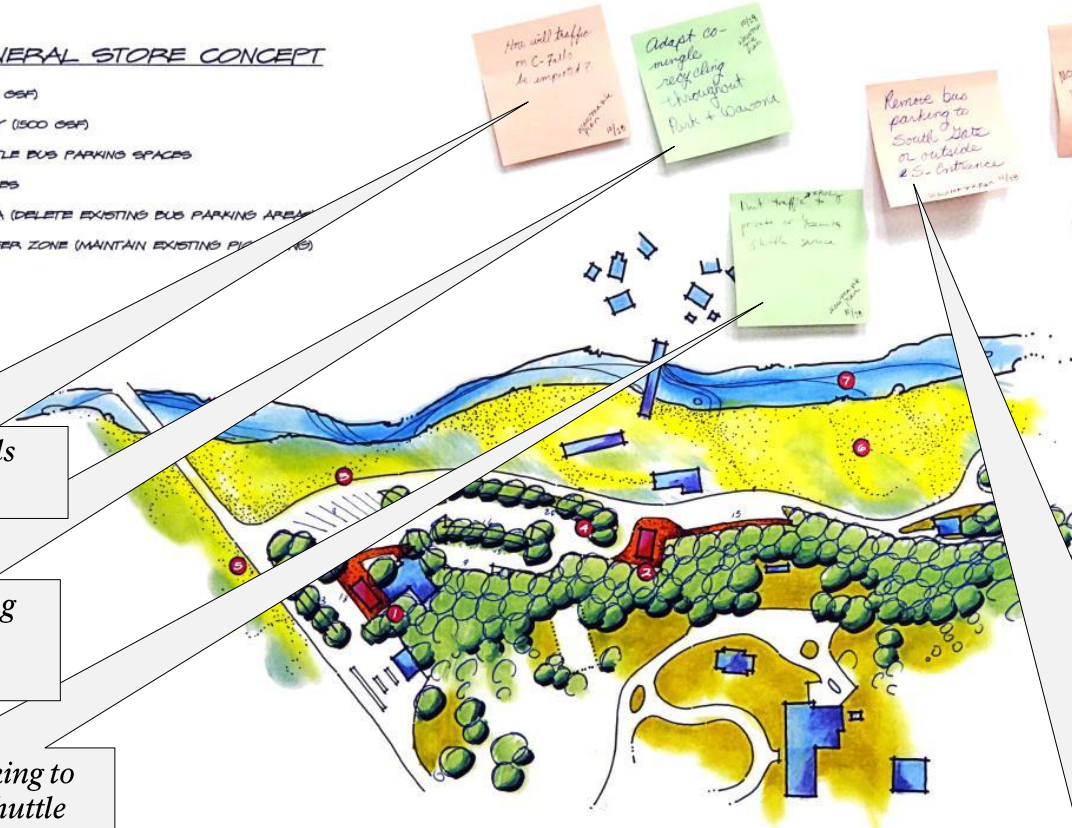

How will traffic on C-Falls be impacted?

Adopt co-mingled recycling throughout Park and Wawona.

Limit traffic and parking to private or Yosemite shuttle service.

More public parking.

When parking at the Mariposa Grove is eliminated where will parking be "relocated"? Wawona is already impacted with parking along Hwy. 41.

Need to add public restrooms at the Swinging Bridge Recreation Area.

Remove bus parking to South Gate or outside South Entrance.



Wawona Maintenance Yard Site Concept Plan

- 1 REHABILITATE EXISTING CCC STRUCTURES FOR POTENTIAL ASYLUM
- 2 EXISTING HISTORIC STRUCTURES WITH NEW PARKING & SIDEWALKS
- 3 POTENTIAL ADDITIONAL TOUR BUS PARKING IN THIS AREA
- 4 50 FT WIDE RESTORATION BUFFER ZONE
- 5 MERCED RIVER



RE: relocation of fire crew etc. to orient to Chilnualna Falls Road – positive concept however need to better understand grade relationships. Seek to minimize appearance of intensity.

Need public restrooms at swimming hole.

Incorporate wood lot into this maintenance yard plan.

Need fueling facility for NPS vehicles.

More public parking. Put overflow from south side of river.

More public parking!

Put more public parking here.

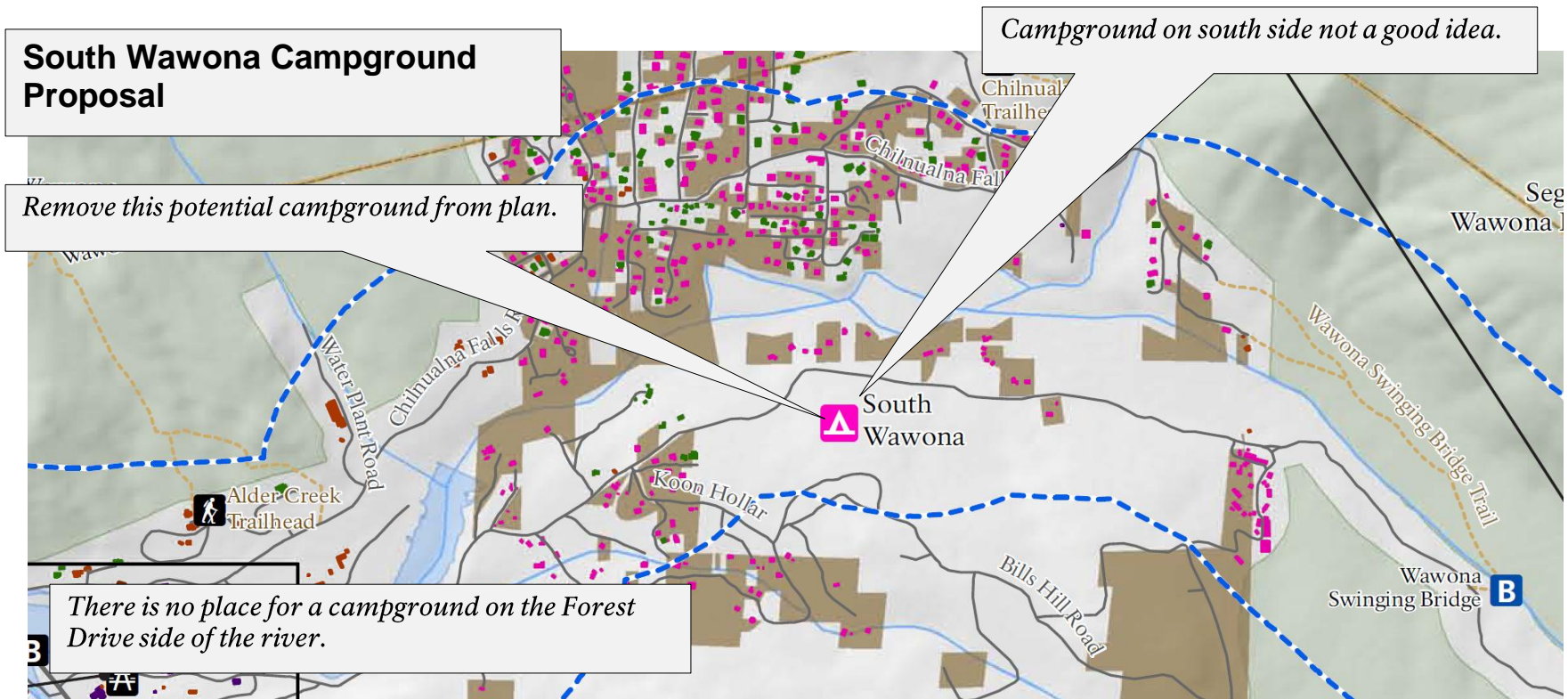



MANAGEMENT CONSIDERATIONS Segment 2.2: Yosemite Village Area

Management Consideration	Option A	Option B	Option C	Comments	Management Consideration	Option A	Option B	Option C	Comments	
Management Consideration 11 Housekeeping, Camp, Equine and Food Waste Impacts Goal: Ecological and Natural Resource Values	Remove all logging units, infrastructure and associated facilities located within the 100-year fire interval within the 100-year fire interval. Where possible, relocate these logging units to other more resilient locations within Yosemite Valley.	Remove all logging units, infrastructure and associated facilities located within the 100-year fire interval within the 100-year fire interval. Where possible, relocate these logging units to other more resilient locations within Yosemite Valley.	Remove all logging units, infrastructure and associated facilities located within the 100-year fire interval within the 100-year fire interval. Where possible, relocate these logging units to other more resilient locations within Yosemite Valley.			Management Consideration 12 Upper and Lower Rivers Campground Areas Goal: Ecological and Natural Resource Values	Provide visitor use opportunities and access to the upper and lower river areas to only the northern portion of the former development area from the Upper and Lower River Campground.	Provide visitor use opportunities and access to the upper and lower river areas to only the northern portion of the former development area from the Upper and Lower River Campground.	Provide visitor use opportunities and access to the upper and lower river areas to only the northern portion of the former development area from the Upper and Lower River Campground.	
Management Consideration 13 Cultural (OHV) Visitor Use Impacts Goal: Opportunities for Direct Connection to River Values	Restrict OHV use to designated areas where practicable to avoid on-going erosion and disturbance. Conduct regular condition assessment monitoring.	Restrict OHV use to designated areas where practicable to avoid on-going erosion and disturbance. Conduct regular condition assessment monitoring.	Restrict OHV use to designated areas where practicable to avoid on-going erosion and disturbance. Conduct regular condition assessment monitoring.		Management Consideration 14 Valley Camping Demand Goal: Visitor Use Management	Restrict camping to the former River Campground.	Restrict camping to the former River Campground.	Restrict camping to the former River Campground.		
Management Consideration 15 Camp & Interceptor Goal: Land Use and Associated Development	Design a stand-alone and pedestrian under-camping to address intersection performance. Due to space considerations, this would likely require that the pedestrian under-camping be moved.	Design a stand-alone and pedestrian under-camping to address intersection performance. Due to space considerations, this would likely require that the pedestrian under-camping be moved.	Design a stand-alone and pedestrian under-camping to address intersection performance. Due to space considerations, this would likely require that the pedestrian under-camping be moved.							

MANAGEMENT CONSIDERATIONS Segment 2.3: Yosemite Lodge Area

Management Consideration	Option A	Option B	Option C	Comments	Management Consideration	Option A	Option B	Option C	Comments	
Management Consideration 16 Yosemite Valley Parking and Trail Impacts Goal: Ecological and Natural Resource Values	Remove all parking and restore meadow. Install benches to provide future parking. Remove the parking on north side of the Yosemite Bridge.	Remove all parking and restore meadow. Install benches to provide future parking. Remove the parking on north side of the Yosemite Bridge.	Remove all parking and restore meadow. Install benches to provide future parking. Remove the parking on north side of the Yosemite Bridge.			Management Consideration 17 Swinging Bridge Riparian Impacts Goal: Ecological and Natural Resource Values	Remove existing parking area and parking for future bathhouse to be located on the north side of the Yosemite Bridge. Designate the area as a formal river access area.	Remove existing parking area and parking for future bathhouse to be located on the north side of the Yosemite Bridge. Designate the area as a formal river access area.	Remove existing parking area and parking for future bathhouse to be located on the north side of the Yosemite Bridge. Designate the area as a formal river access area.	
Management Consideration 18 Yosemite Valley Parking and Trail Impacts Goal: Visitor Use Management	Prohibit all parking and trail use along the valley. Summertime and winter use would continue to be allowed.	Prohibit all parking and trail use along the valley. Summertime and winter use would continue to be allowed.	Prohibit all parking and trail use along the valley. Summertime and winter use would continue to be allowed.		Management Consideration 19 Yosemite Valley Parking and Trail Impacts Goal: Visitor Use Management	Prohibit all parking and trail use along the valley. Summertime and winter use would continue to be allowed.	Prohibit all parking and trail use along the valley. Summertime and winter use would continue to be allowed.	Prohibit all parking and trail use along the valley. Summertime and winter use would continue to be allowed.		
Management Consideration 20 Valley Camping Demand Goal: Visitor Use Management	Restrict camping to the former River Campground.	Restrict camping to the former River Campground.	Restrict camping to the former River Campground.		Management Consideration 21 Yosemite Lodge Interceptor Congestion Goal: Land Use and Associated Development	Restrict camping to the former River Campground.	Restrict camping to the former River Campground.	Restrict camping to the former River Campground.		



MANAGEMENT CONSIDERATIONS Segment 2.4: West Yosemite Valley











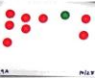

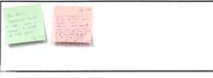
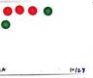
Management Consideration 21 El Cap Meadow Informal Social Trails Goal: Ecological and Natural Resource Values	Informal trails and vegetation burning in the El Cap meadow impacts visitor safety, scenic values, and resource values.	Option A Use vegetation burning to limit trail traffic into the meadow and designate appropriate access routes using boardwalks and viewing platforms.	Option B Use vegetation burning to limit trail traffic into the meadow and designate appropriate viewing access points at more resilient locations.	Option C Selectively remove vegetation that is blocking roadside views of El Capitan.	Option D Limit most meadow parking to search and rescue and other emergency use. Consolidate visitor roadside parking along the west end of the meadow, keep parking open for SRM and other access traffic.	Comments
Management Consideration 22 West of Pohono Bridge, River Access Goal: Visitor Use Management	There are no design alternatives for this area with existing and future parking and visitor use.	Option A Phase limited parking area and designate access to the river, use parking to formalize parking. Use marking or coloring to limit additional informal parking.	Option B Close this access point, block parking access on both sides of the road access to river is available at other sites in the corridor.	Option C Designate river access and use boardwalks to limit parking in an paved parking area.	Comments	Management Consideration 23 Valley Camping Demand Goal: Visitor Use Management
Management Consideration 24 Cathedral Beach Picnic Area Goal: Land Uses and Development	The Cathedral Beach picnic area is a high-use area with existing parking and picnic tables. The resulting loss of riparian vegetation contributes to nonpoint erosion.	Option A Re-design picnic area to better manage the level of visitor use and designate the area as a formal river access point. Remove off sensitive area, re-direct use to more resilient areas and establish riparian vegetation.	Option B Retain existing picnic area, designate the area as a formal river access point. Remove off sensitive area and establish riparian vegetation.	Comments	Management Consideration 25 Sentinel Beach Picnic Area Goal: Land Uses and Development	
Management Consideration 26 Greenough Sanjipit: Flood and Riparian Plant Impacts from Fill Material Goal: Ecological and Natural Resources Values	Greenough Sanjipit contains riparian habitat that provides natural flooding and regeneration of riparian plant communities.	Option A Restore to natural conditions, remove fill material and reconstruction.	Option B Cultivate fill material to allow flooding cycles and other natural processes to flush the site gradually and re-establish the flood plain.	Option C Using best management practices, continue administrative functions including staging and biomass management.	Comments	
Management Consideration 27 Infrastructure Impacts: Valley Oaks Goal: Ecological and Natural Resources Values	Infrastructure built at facilities and parking lot among the Valley Oaks providing significant recruitment in its habitat.	Option A Remove all facilities and restore the understory.	Option B Repurpose sites as needed. Restore area where infrastructure is removed to natural conditions.	Option C Retain facilities but create an other seating recruitment area in a different location.	Comments	
Management Consideration 28 Maintenance Administrative Complex Roadside Parking Goal: Land Use and Associated Development	The off-street and roadside parking area located between the Administrative Complex and Foresta Road were not designed or built to prevent water quality contamination from automotive fluids, surface water runoff or sediment deposition.	Option A Construct mitigation measures (Best Management Practices) and formalize existing parking area to maximize visitor and employee parking within the existing footprint.	Option B Relocate parking from the river's edge. Build new parking east of Foresta Road at the Administrative Facility. Restore sites between Foresta Road and the river.	Comments		

MANAGEMENT CONSIDERATIONS Segment 4: El Portal

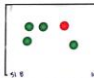
Management Consideration 26 Greenough Sanjipit: Flood and Riparian Plant Impacts from Fill Material Goal: Ecological and Natural Resources Values	Greenough Sanjipit contains riparian habitat that provides natural flooding and regeneration of riparian plant communities.	Option A Restore to natural conditions, remove fill material and reconstruction.	Option B Cultivate fill material to allow flooding cycles and other natural processes to flush the site gradually and re-establish the flood plain.	Option C Using best management practices, continue administrative functions including staging and biomass management.	Comments
Management Consideration 27 Infrastructure Impacts: Valley Oaks Goal: Ecological and Natural Resources Values	Infrastructure built at facilities and parking lot among the Valley Oaks providing significant recruitment in its habitat.	Option A Remove all facilities and restore the understory.	Option B Repurpose sites as needed. Restore area where infrastructure is removed to natural conditions.	Option C Retain facilities but create an other seating recruitment area in a different location.	Comments
Management Consideration 28 Maintenance Administrative Complex Roadside Parking Goal: Land Use and Associated Development	The off-street and roadside parking area located between the Administrative Complex and Foresta Road were not designed or built to prevent water quality contamination from automotive fluids, surface water runoff or sediment deposition.	Option A Construct mitigation measures (Best Management Practices) and formalize existing parking area to maximize visitor and employee parking within the existing footprint.	Option B Relocate parking from the river's edge. Build new parking east of Foresta Road at the Administrative Facility. Restore sites between Foresta Road and the river.	Comments	

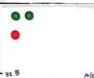

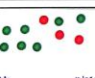
MANAGEMENT CONSIDERATIONS Segment 3 - South Fork Merced River

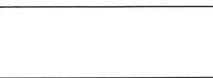
<p>Management Consideration 29 Wawona Campground activity near river</p> <p>Goal: Ecological and Natural Resources Values</p>	<p>Option A Relocate or close camp sites that are too close to the river</p> 	<p>Option B Relocate or close camp sites that are too close to the river</p> 	<p>Comments</p> 	<p>Management Consideration 30 Camp A.E. Wood</p> <p>Goal: Opportunities for Direct Connection to River Values</p>	<p>Option A Stabilize archeological remains of Camp and provide a site to visit. Provide interpretive display highlighting the importance of Camp A.E. Wood as an example of African-American soldiers in park history as well as archeological stewardship.</p> 	<p>Option B Conduct data recovery of archeological remains of Camp. Provide interpretive display highlighting the importance of Camp A.E. Wood as an example of African-American soldiers in park history.</p> 	<p>Comments</p> 
<p>Management Consideration 31 South Fork paddling and floating</p> <p>Goal: Visitor Use Management Program</p>	<p>Option A Public comment. No structural improvement to existing floating and boating facilities in this segment.</p> 	<p>Option B Continue to allow paddling and floating in this segment with designated put-in and take-out for the Wawona Store and limit on the number of boats per year. No limits on recreational floating and related water play.</p> 	<p>Comments</p> 	<p>Management Consideration 32 Picnic area near Wawona Store</p> <p>Goal: Land Uses and Associated Development</p>	<p>Option A The existing picnic area at Wawona is an excellent example of a well-maintained and popular picnic area for river use and parking.</p> 	<p>Option B Redesign picnic area in its current location, designate river access.</p> 	<p>Comments</p> 
<p>Management Consideration 33 Impoundment: Effects on Free-Flowing Condition</p> <p>Goal: Land Uses and Associated Development</p>	<p>Option A Surface water with impoundment that affects the free-flowing condition of the river. Investigate water with impoundment that affects the free-flowing condition of the river. Investigate water with impoundment that affects the free-flowing condition of the river.</p> 	<p>Option B Investigate responsible options, such as water system development from Bridge Spring or Big Creek. Repair the impoundment and other options are developed.</p> 	<p>Comments</p> 	<p>Comments</p> 